

CTP4555 is a medium current inductor with the following data and features:

- **Core type:** 1.06" o.d., Moly-Permalloy Powder, perm 60.
 - **Power rating:** 2.16 watts for temp. rise 50°C.
 - **Typical applications:** Switching Inductors in Switch Mode Power Supplies.
- Four mounting styles are offered:**
- 1 Flying leads (1.00"), for vertical or horizontal mounting.
 - 2 4-pin header, for vertical mounting.
 - 3 Threaded center hole, flying leads (2.00").
 - 4 2-pin header, for vertical mounting.



MECHANICAL

Style 1

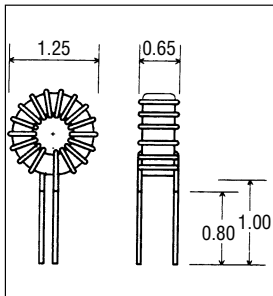

Style 2

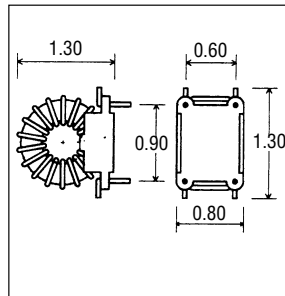

Style 3

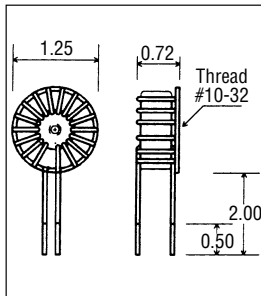

Style 4

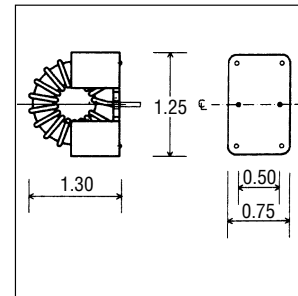

ELECTRICAL SPECIFICATION

Ordering Information: Substitute the style number for the asterisk (*). Example: CTP4555, Style 1, 56uH. Order: CTP4555 - 116

| Part No. CTP4555 - | Ind. (uH) | DCR Ohms | Rated Current Amp. RMS | I (amp.) @ Lsat. 10% | I (amp.) @ Lsat. 25% | I (amp.) @ Lsat. 50% | Part No. CTP4555 - | Ind. (uH) | DCR Ohms | Rated Current Amp. RMS | I (amp.) @ Lsat. 10% | I (amp.) @ Lsat. 25% | I (amp.) @ Lsat. 50% |
|--------------------|-----------|----------|------------------------|----------------------|----------------------|----------------------|--------------------|-----------|----------|------------------------|----------------------|----------------------|----------------------|
| * 01 | 3.3 | 0.005 | 16.2 | 14.4 | 23.9 | 39.9 | * 17 | 68 | 0.032 | 6.2 | 3.2 | 5.3 | 8.8 |
| * 02 | 3.9 | 0.005 | 15.5 | 13.2 | 22.0 | 36.7 | * 18 | 82 | 0.035 | 5.9 | 2.9 | 4.8 | 8.0 |
| * 03 | 4.7 | 0.005 | 14.9 | 12.0 | 20.1 | 33.4 | * 19 | 100 | 0.038 | 5.6 | 2.6 | 4.3 | 7.2 |
| * 04 | 5.6 | 0.006 | 14.3 | 11.0 | 18.4 | 30.6 | * 20 | 120 | 0.042 | 5.4 | 2.4 | 4.0 | 6.6 |
| * 05 | 6.8 | 0.006 | 13.6 | 10.0 | 16.7 | 27.8 | * 21 | 150 | 0.047 | 5.1 | 2.1 | 3.5 | 5.9 |
| * 06 | 8.2 | 0.007 | 13.0 | 9.1 | 15.2 | 25.3 | * 22 | 180 | 0.064 | 4.3 | 1.9 | 3.2 | 5.4 |
| * 07 | 10 | 0.008 | 12.4 | 8.2 | 13.7 | 22.9 | * 23 | 220 | 0.090 | 3.6 | 1.8 | 2.9 | 4.9 |
| * 08 | 12 | 0.009 | 11.9 | 7.5 | 12.5 | 20.9 | * 24 | 270 | 0.125 | 3.1 | 1.6 | 2.6 | 4.4 |
| * 09 | 15 | 0.009 | 11.2 | 6.7 | 11.2 | 18.7 | * 25 | 330 | 0.138 | 2.9 | 1.4 | 2.4 | 4.0 |
| * 10 | 18 | 0.010 | 10.8 | 6.1 | 10.2 | 17.1 | * 26 | 390 | 0.190 | 2.5 | 1.3 | 2.2 | 3.7 |
| * 11 | 22 | 0.011 | 10.2 | 5.6 | 9.3 | 15.4 | * 27 | 470 | 0.208 | 2.4 | 1.2 | 2.0 | 3.3 |
| * 12 | 27 | 0.013 | 9.7 | 5.0 | 8.4 | 13.9 | * 28 | 560 | 0.227 | 2.3 | 1.1 | 1.8 | 3.1 |
| * 13 | 33 | 0.018 | 8.3 | 4.5 | 7.6 | 12.6 | * 29 | 680 | 0.251 | 2.2 | 1.0 | 1.7 | 2.8 |
| * 14 | 39 | 0.024 | 7.1 | 4.2 | 7.0 | 11.6 | * 30 | 820 | 0.275 | 2.1 | 0.9 | 1.5 | 2.5 |
| * 15 | 47 | 0.026 | 6.8 | 3.8 | 6.3 | 10.6 | * 31 | 1000 | 0.383 | 1.8 | 0.8 | 1.4 | 2.3 |
| * 16 | 56 | 0.029 | 6.5 | 3.5 | 5.8 | 9.7 | * 32 | 1200 | 0.531 | 1.5 | 0.8 | 1.3 | 2.1 |

CTP4555